

ELECTRICAL CHARACTERISTICS

Insulation Resistance: 1000M Ohm Min.at 250V DC
 Contact Resistance: 20m Ohm Max
 Operating Temperature: -55°C~+85°C

MATERIALS:

Contacts: Copper alloy ,Thickness=0.3±0.05mm
 Insulator: NYLON or LCP UL 94V-O.
 Shell: Cold Roller Steel or Brass,Nikel plated

Ordering Information

2076 P 0 * 0 M * *
 1 2 3 4 5 6 7 8

RoHS COMPLIANT

1. Series No.
2. P = Plug
3. 0 = Single
4. Contact Plating:
 F = Selective gold flash over
 30µ"min. nickel plated overall
 K = 30µ"min.selective gold plated over
 30µ"min. nickel overall
5. Type: 0=A TYPE
6. M:SMT
7. Color:1=Black 2=White 0=Ivory
8. Option:

	φ A	φ B
A	φ 1.400	φ 1.500
L	φ 1.000	φ 1.100

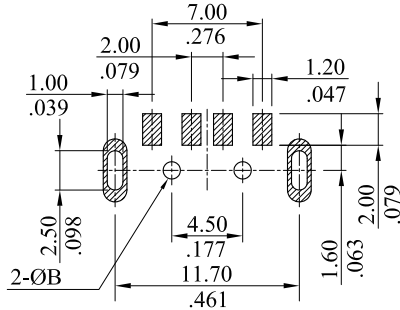

RECOMMAND PCB LAYOUT
 TOLERANCES:±0.10

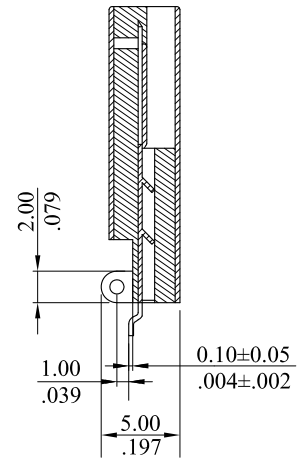
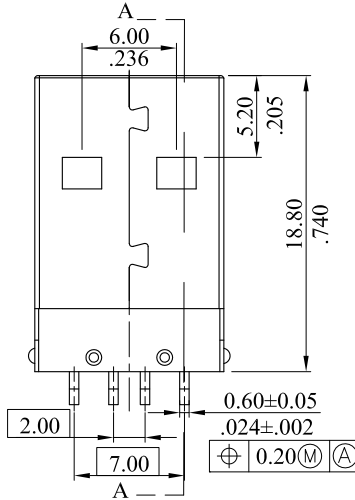
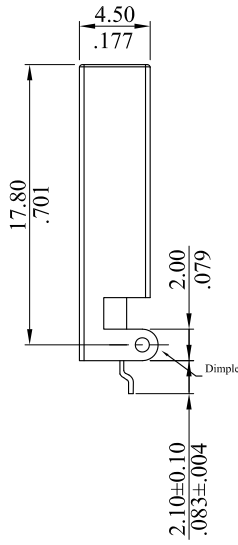
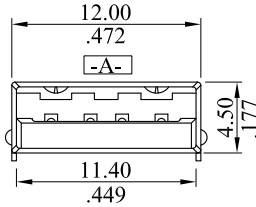

SECTLON A-A

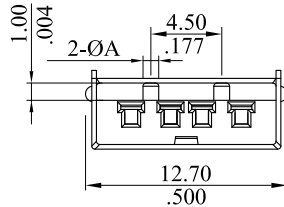

G	ES101222			LECO CORPORATION GENERAL TOLERANCES: (UNLESS SPECIFIED) <table border="1"> <thead> <tr> <th></th> <th>mm</th> <th>inch</th> </tr> </thead> <tbody> <tr> <td>1 PLACE</td> <td>± 0.30</td> <td>± ---</td> </tr> <tr> <td>2 PLACES</td> <td>± 0.20</td> <td>± .012</td> </tr> <tr> <td>3 PLACES</td> <td>± 0.10</td> <td>± .008</td> </tr> <tr> <td>4 PLACES</td> <td>± ---</td> <td>± .004</td> </tr> </tbody> </table> ANGULAR ± (1°)		mm	inch	1 PLACE	± 0.30	± ---	2 PLACES	± 0.20	± .012	3 PLACES	± 0.10	± .008	4 PLACES	± ---	± .004	APPROVED:	PART NO.:			
	mm	inch																						
1 PLACE	± 0.30	± ---																						
2 PLACES	± 0.20	± .012																						
3 PLACES	± 0.10	± .008																						
4 PLACES	± ---	± .004																						
F	ES090231			DATE:	2076P0*0M**																			
E	ES080814			CHECKED:	TITLE:																			
D	ES080759			DATE:	USB A SMT TYPE PLUG																			
C	ES071037			DRAWN:	DRAWING NO.:																			
REV.	ECO. NO.	CHG.	APP.	DATE:	207622S																			
					UNITS	SCALE	SIZE	SHEET	REV.															
					mm inch	2:1	A4	1/1	G															