

RoHS COMPLIANT

CUSTOMER DRAWING			
REV.	ECO. NO.	DESCRIPTION	DATE
A	DWG. REL.	APPROVED	2018.01.26
B	ES190411	B-6:Modify the plating code "1"to"0"	2019.04.24

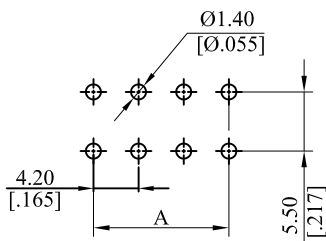

Recommended P.C.B Layout
General Tolerance ±0.05

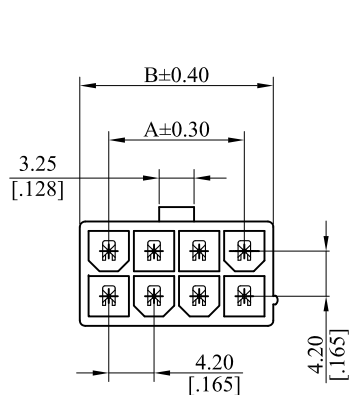
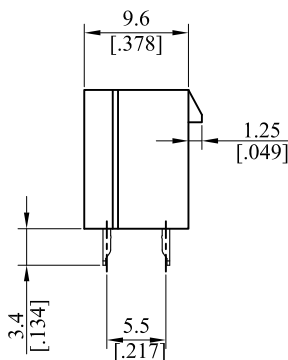
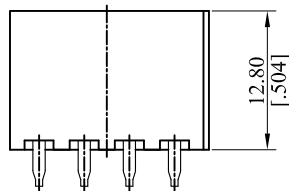

Note:

Material:

Insulator: Thermoplastic

Contact: Brass

General part number:

6745P ** V * 0 *
1 2 3

1. No.of circuits(02~24)

2. Plated:

0= Tin plated 120µ"min.over 30µ"min.Nickel underplating overall

U= Gold flash over 30µ"min.Nickel underplating overall

W= 15µ"min.Gold over30µ"min.Nickel underplating overall

3. 0=UL 94V-2 without screw hole and mounting pegs,Natural

1=UL 94V-0 without screw hole and mounting pegs,White

A=4.20mm(.165")*No. of Spaces

B=A+5.40mm(.213")

Detail Circuit Pattern Schedule:



2 Circuits

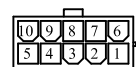

10 Circuits

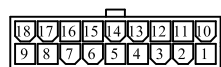

18 Circuits



4 Circuits

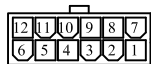

12 Circuits



20 Circuits



6 Circuits

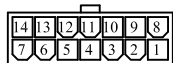

14 Circuits

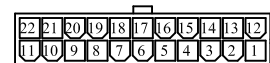

22 Circuits

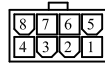

8 Circuits

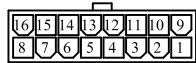

16 Circuits

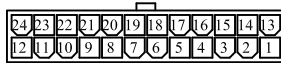

24 Circuits

TOLERANCE UNLESS OTHERWISE SPECIFIED			LEOCO CORPORATION http://www.leoco.com.tw		
mm	mm	inch	APPROVED BY:	DATE:	TITLE:
[inch]			Chard	2019.04.24	4.2mm Pitch V Type Power Connector
1 PLACE	± 0.30	± ---	CHECKED BY:	DATE:	
2 PLACES	± 0.20	± .012	Angel	2019.04.24	PART NO.: 6745P**V*0*
3 PLACES	± 0.10	± .008	DRAWN BY:	DATE:	
4 PLACES	± ---	± .004	Dylan	2019.04.24	DRAWING NO.: 674531S
ANGULAR ±1°			SIZE: A3	SCALE: 1:1	REV.: B
			SHEET: 1 OF 1		