

## 8100/8111 Series

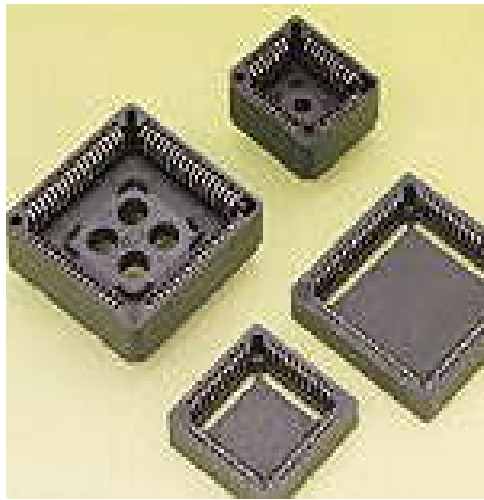

### Features

#### ◆ 8100 Socket:

- Compact design
- Prevents damage from IC device through a fully
- Mates with 1.57mm(.062") thick P.C.Board
- Insulator: UL94V-0 PBT or PPS
- Contact: Phosphor bronze

#### ◆ 8111 Socket:

- Surface mount type
- Insulator: P.P.S.+40% UL94V-0
- Contact: Phosphor bronze

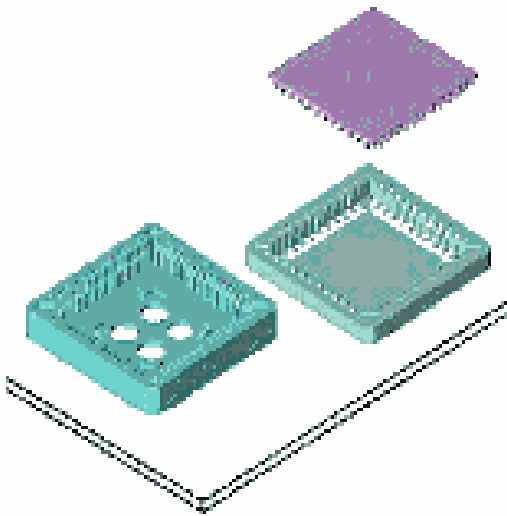

### Specifications

- ◆ Current rating: 1A AC,DC
- ◆ Voltage rating: 250V AC,DC
- ◆ Temperature rating: -40°C ~ +105°C
- ◆ Contact resistance:
  - Initial: 20mΩ max.
  - After environmental test: 40mΩ max.
- ◆ Insulation resistance:
  - Initial: 1,000MΩ min.
  - After humidity and thermal shock test: 500MΩ min
- ◆ Withstanding voltage: 600V AC /minute
- ◆ Applicable PC board thickness: 1.6mm

### Standards

 Recognized No. E82349(8100)

Ordering Information :

8100 - \*\* \* 0 \*\*  
 1 2 3

1. No. of circuits
2. Plating :  
 T= Tin plated 100μ" over 30~50μ" nickel overall  
 U= Gold flash over 30~50μ" nickel overall
3. Special option.  
 00 = Color: Brown , UL94V-0 PPS  
 01 = Color: Light Brown (PANTONE NO:464U), UL94V-0 PPS  
 B0 = Color: Black , UL94V-0 PBT

Unit:  $\frac{\text{mm}}{\text{inch}}$

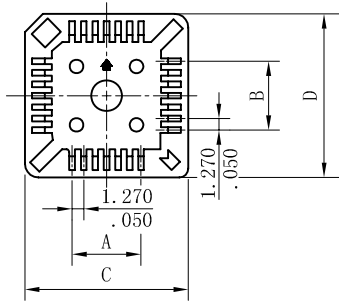

For 20, 28 and 32 circuits

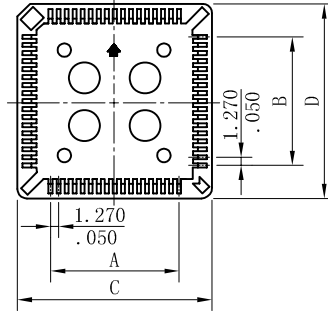

For 44, 52, 68 and 84 circuits

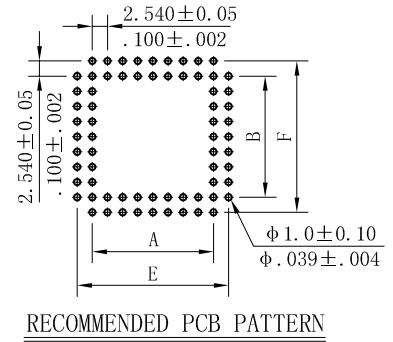

RECOMMENDED PCB PATTERN

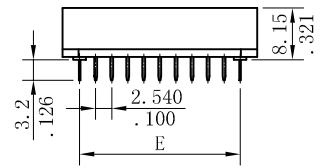

Contact	Dim. A ± 0.10	Dim. B ± 0.10	Dim. C ± 0.20	Dim. D ± 0.20	Dim. E ± 0.20	Dim. F ± 0.10
20	5.08 (.200)	5.08 (.200)	15.56 (.613)	15.56 (.613)	10.16 (.400)	10.16 (.400)
28	7.62 (.300)	7.62 (.300)	18.10 (.713)	18.10 (.713)	12.70 (.500)	12.70 (.500)
32	7.62 (.300)	10.16 (.400)	18.10 (.713)	20.54 (.809)	12.70 (.500)	15.24 (.600)
44	12.70 (.500)	12.70 (.500)	23.18 (.913)	23.18 (.913)	17.78 (.700)	17.78 (.700)
52	15.24 (.600)	15.24 (.600)	25.72 (1.013)	25.72 (1.013)	20.32 (.800)	20.32 (.800)
68	20.32 (.800)	20.32 (.800)	30.80 (1.213)	30.80 (1.213)	25.40 (1.000)	25.40 (1.000)
84	25.40 (1.000)	25.40 (1.000)	35.88 (1.413)	35.88 (1.413)	30.48 (1.200)	30.48 (1.200)

Ordering Information:

8111- \*\* TA \* 2  
 1 2

1. No. of Circuits
2. Packing: B = Tube  
 R = Tape & Reel

Unit:  $\frac{\text{mm}}{\text{inch}}$

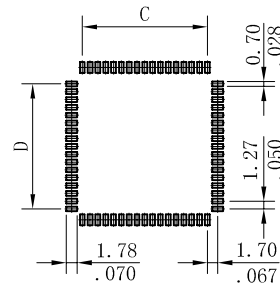
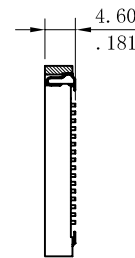
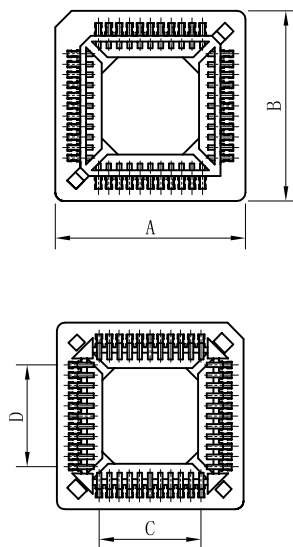

RECOMMENDED PCB PATTERN

Contact	Dim. A ± 0.2	Dim. B ± 0.2	Dim. C ± 0.1	Dim. D ± 0.1
20	15.58 (.613)	15.58 (.613)	5.08 (.200)	5.08 (.200)
28	18.12 (.713)	18.12 (.713)	7.62 (.300)	7.62 (.300)
32	18.12 (.713)	20.66 (.813)	7.62 (.300)	10.16 (.400)
44	23.20 (.913)	23.20 (.913)	12.70 (.500)	12.70 (.500)
52	25.74 (1.013)	25.74 (1.013)	15.24 (.600)	15.24 (.600)
68	30.82 (1.213)	30.82 (1.213)	20.32 (.800)	20.32 (.800)
84	35.90 (1.413)	35.90 (1.413)	25.40 (1.000)	25.40 (1.000)