

2006/2007/2566/2666 Series



Features

◆ 2006 and 2007 Header:

- 2006 available in 2 through 40 circuits
- 2007 available in 4 through 80 circuits
- Glass filled polyester UL94V-0
- Low profile
- With standoff
- Easy breakaway to desired circuits
- Stackable end to end
- 0.50mm(.020") square pin
- Pin length and plating options are available
- 2006 mates with Leoco 2065 and 2041 socket
- 2007 mates with Leoco 2066 and 2042 socket

◆ 2566 and 2666 Header:

- 2566 : 40 circuits as standard size
- 2666 : 80 circuits as standard size
- Glass filled polyester UL94V-0
- Color : Black
- With standoff minimize flux wicking
- Easy breakaway to desired circuits
- Stackable end to end
- 0.64mm(.025") square pin
- Pin length : maximum 32mm(1.26")
- Plating options are available
- Pin omit options are available in any circuits

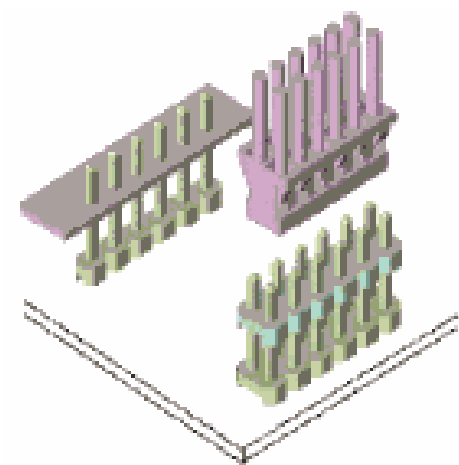

Specifications

- ◆ Current rating:
 - 2006 and 2007 : 1A DC,AC
 - 2566 and 2666 : 3A AC
- ◆ Voltage rating: 250V DC
- ◆ Temperature rating: -40°C ~ +105°C
- ◆ Contact resistance:
 - Initial:20mΩ max.
 - After environmental test:40mΩ max.
- ◆ Insulation resistance:
 - Initial:1,000MΩ min.
 - After humidity and thermal shock test:500MΩ min.
- ◆ Withstanding voltage: 500V AC /minute
- ◆ Applicable PC board thickness: 1.6mm

Standards



Recognized No. E82349 (2566)



Licensed No. R50017086 (2566)

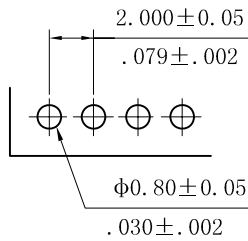
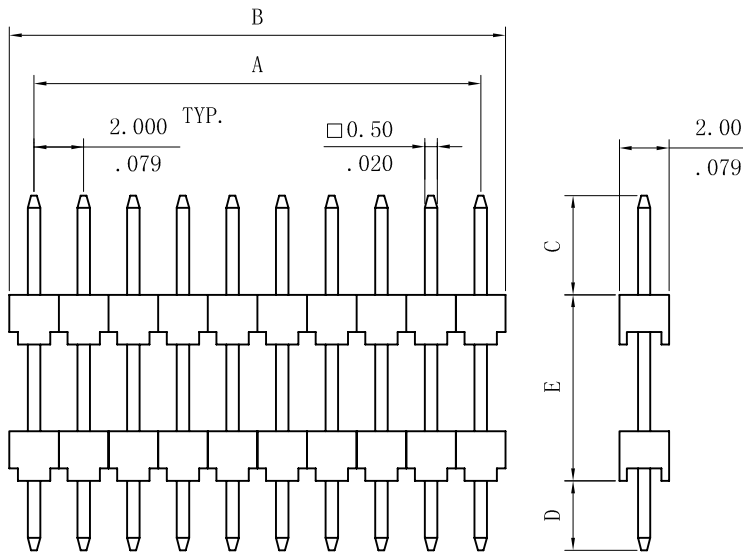

RECOMMENDED HOLE PATTERN

Ordering Information:

2006 P $\frac{**}{1} \frac{*}{2} \frac{L}{3}$

- No. of circuits available in 2 through 40 circuits
- Plating:
 - F=Selective gold flash over 30~50 u" nickel overall
 - J=15 u" gold plated selective over 30~50 u" nickel overall
 - K=30 u" gold plated selective over 30~50 u" nickel overall
 - T=Tin plated 120 u" min. over 30~50 u" nickel overall
 - U=Gold flash over 30~50 u" nickel overall
 - W=15 u" gold over 30~50 u" nickel overall
 - Z=30 u" gold over 30~50 u" nickel overall
 - G=50 u" gold over 30~50 u" nickel overall
- Special options:
 - Pin Length = Dim. C + Dim. D + Dim. E

$A = 2.00\text{mm}(.079") * \text{No. of Spaces}$

$B = A + 2.00\text{mm}(.079")$

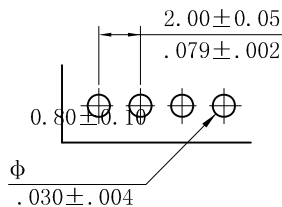
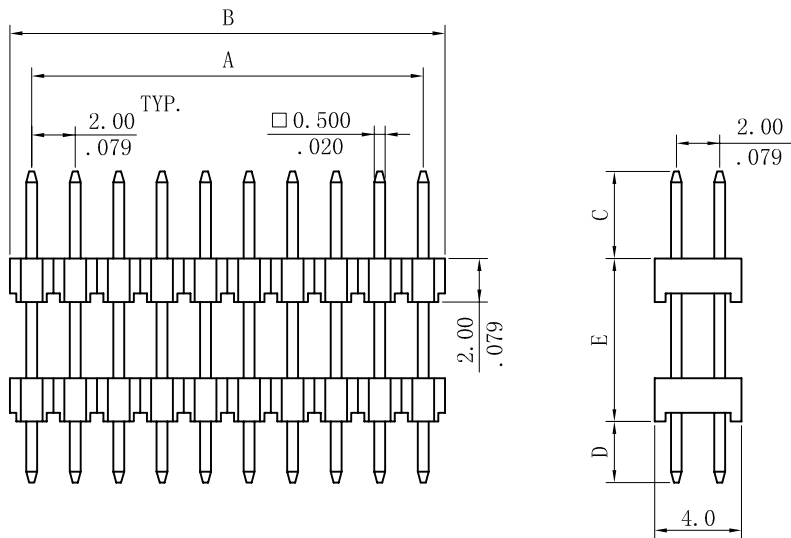

RECOMMENDED HOLE PATTERN

Ordering Information:

2007 P $\frac{**}{1} \frac{*}{2} \frac{L}{3}$

- No. of circuits:
- Contact plating:
 - T=Tin plated 120 u" min. over 30~50 u" nickel overall
 - U=Gold flash over 30~50 u" nickel overall
 - W=15 u" gold over 30~50 u" nickel overall
 - Z=30 u" gold over 30~50 u" nickel overall
- Special options: u"

Pin Length = Dim. C + Dim. D + Dim. E

$A = 2.00\text{mm}(.079") * \text{No. of Spaces}$

$B = A + 2.00\text{mm}(.079")$



TYP.

T= Tin plated 120 min. over 30~50 nickel overall

Pin Length=Dim. C+Dim. D+Dim. E

Unit: $\frac{\text{mm}}{\text{inch}}$

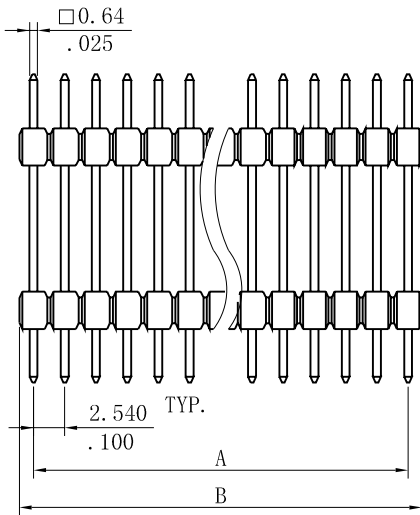

A = 2.54mm(.100") * No. of Spaces
 B = A + 2.54mm(.100")

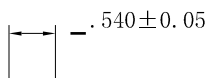

φ

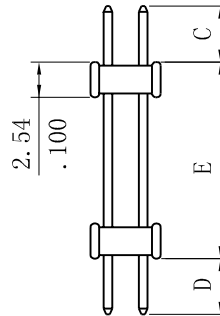

Ordering Information :

2666P $\frac{**}{1} \frac{*}{2} \frac{L**}{3}$

1. No. of circuits
2. Contact plating

T = Tin plated 120 u" min. over 30~50 u" nickel overall

U = Gold flash over 30~50 u" nickel overall

W = 15 u" gold over 30~50 u" nickel overall

Z = 30 u" gold over 30~50 u" nickel overall

3. Pin length code

Pin Length=Dim. C+Dim. D+Dim. E