

## 1250/1251 Series

### Features

#### ◆ 1250 Socket

Mates with Leoco 1251 header

#### ◆ 1251 Header

Mates with Leoco 1250 socket

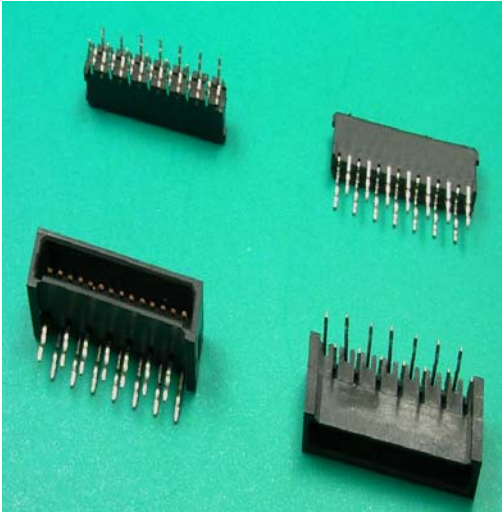

### Material

◆ Base material: Nylon66+15%GF, UL94V-0, Black

◆ Contact: Phosphor Bronze

◆ Plating: Tin

### Specifications

#### ◆ Electrical performance

Contact resistance:  $20\text{M}\Omega$  MAX

Dielectric withstanding voltage: 250V, 1 minute Max.

loading pressure and electric current 125V 1A

Insulation resistance:  $500\text{M}\Omega$  MIN.

#### ◆ Mechanical performance :

Contact removal force: 4.9N(500gf)Min.

Insertion force: 450g Max. Withdrawal force: 50g Min.

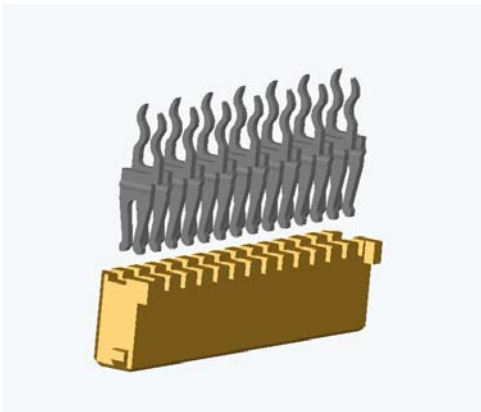

# 1250

Series 1.25mm(.049")PCB Connector



Unit:  $\frac{\text{mm}}{\text{inch}}$

1250S140000

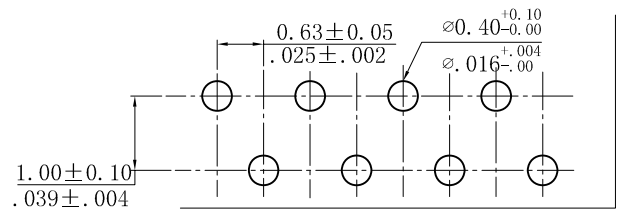
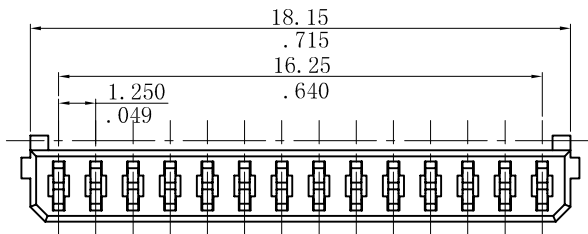
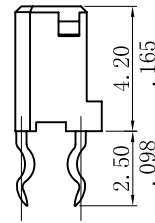
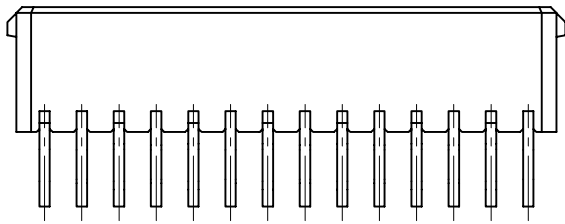

RECOMMENDED HOLE PATTERN

# 1251

Series 1.25mm(.049")PCB Connector



Unit:  $\frac{\text{mm}}{\text{inch}}$

1251P140000

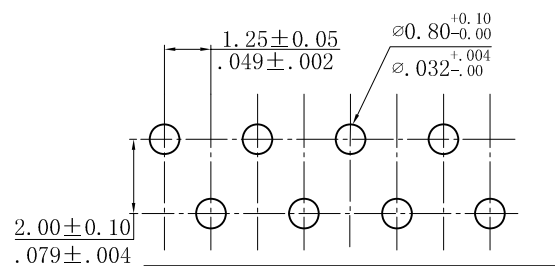
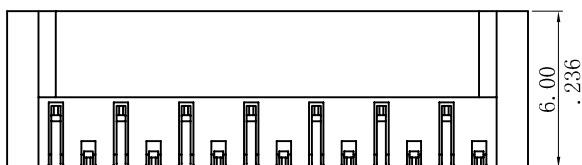
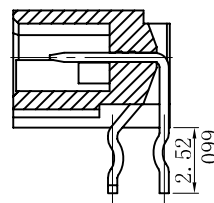
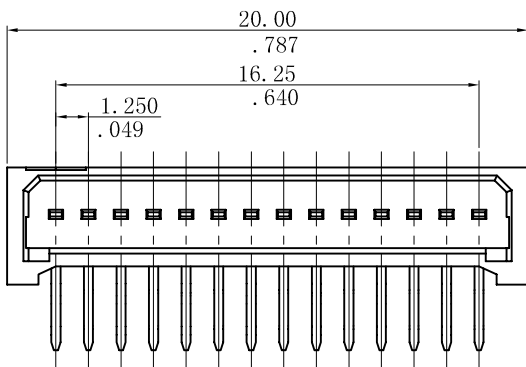

RECOMMENDED HOLE PATTERN