

1050 Series

Features

◆ 1050 Housing:

Available in 20 and 30 circuits

Insulator : PA46, UL94V-0

Accepts Leoco 1050 crimp terminal

◆ 1050 Terminal:

Accommodate wire range AWG 30~34

Use in Leoco 1050 series socket

Material: Phosphor bronze

Specifications

◆ Current rating: 1A AC,DC

◆ Voltage rating: 200V AC,DC

◆ Temperature rating: -40°C to +80°C

◆ Contact Resistance: 40mΩ Max.

◆ Insulation Resistance: 100MΩ Min.

◆ Withstanding Voltage: 500V AC/minute

1050

Series 1.00mm(.039")Crimp Type Socket



Ordering Information:

1050S ** 0000
1

1. No. of circuits

Unit: $\frac{\text{mm}}{\text{inch}}$

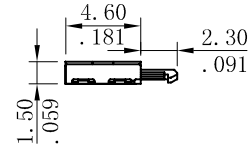
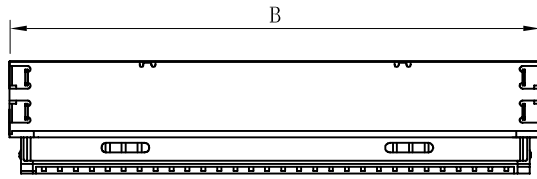
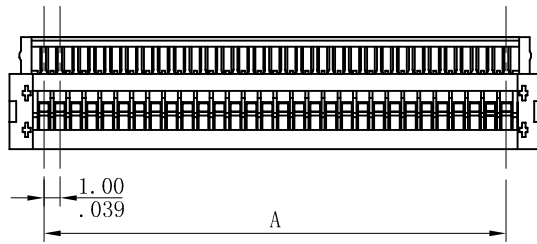

$$A = 1.0\text{mm} (.039") \times \text{No. of spaces}$$

$$B = A + 4.3\text{mm} (.169")$$

1050

Series 1.00mm(.039")Crimp Terminal



Ordering Information:

1050TPBF000

Material: Phosphor Bronze

Wire Range: AWG30~34

Reel Q'ty: 30,000PCS

Unit: $\frac{\text{mm}}{\text{inch}}$

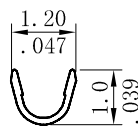
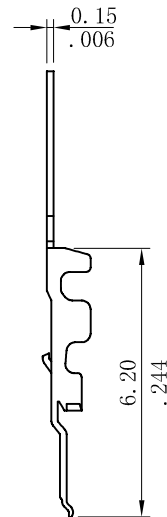
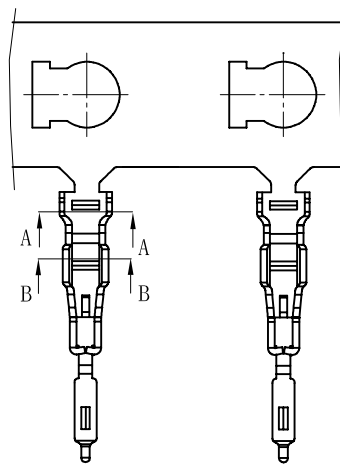

SECTION A-A

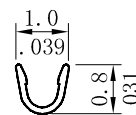

SECTION A-A